

Bidet Seat Cover

Installation Instructions

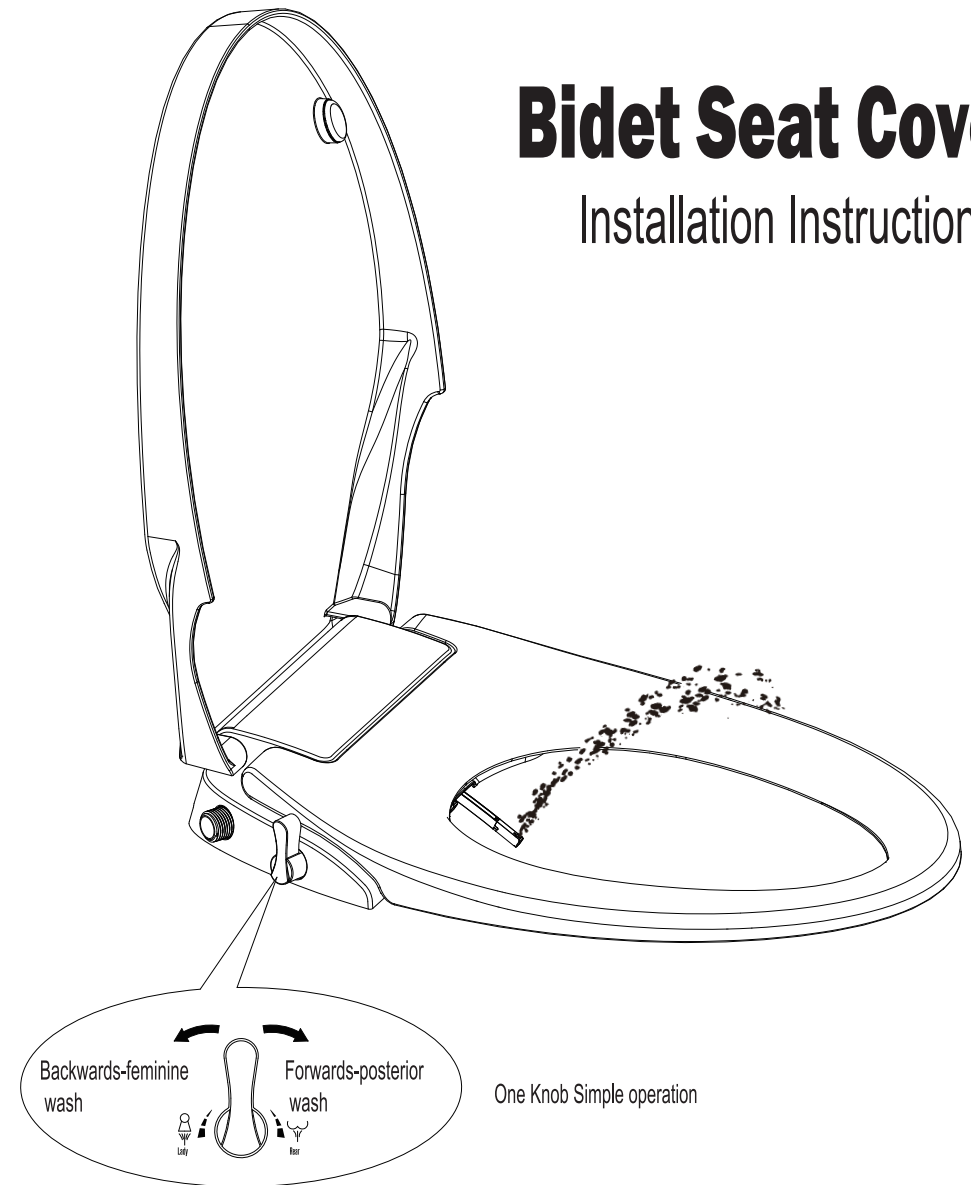

SPECIFICATIONS

| Classification | Description |
|--------------------------|-----------------------------|
| Model | A1002-103-03 |
| Posterior wash flow rate | 0.35 - 1.8 L/min |
| Feminine wash flow rate | 0.35 - 1.8 L/min |
| Water supply | Tap water |
| Water pressure range | Static pressure:0.07-0.8MPa |

CAUTION

Please do not disassemble, repair, or modify the product.
The water supply must be potable (drinking) water. Rain water, grey water or recycled water must not be used as doing so may lead to skin irritation or infection.

ASSEMBLY DRAWING

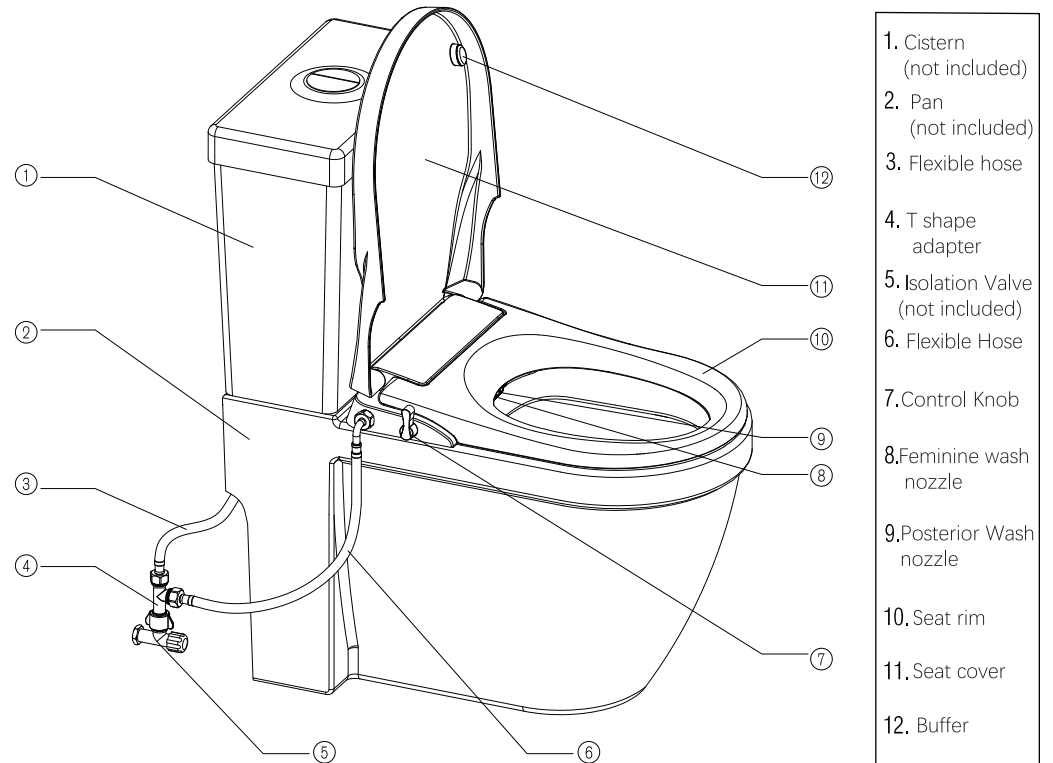

COMPONENTS

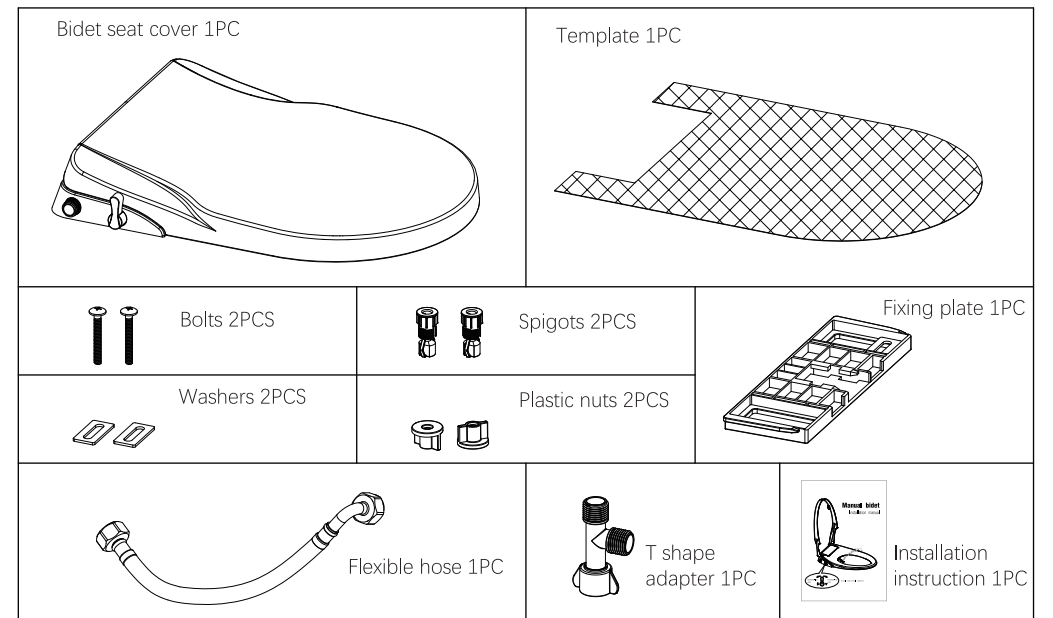

INSTALLATION PROCEDURE

1. The below procedure shows top installation. For bottom installation, where access to the underside of the pan is available, the plastic nuts are used instead of the spigots (step 2) ;
2. The product can be connected to a warm water supply, however, the water temperature must not exceed 40°C. A tempering valve should be installed in order to avoid injury ;
3. The supply water pressure must be between : 0.07-0.8MPa ; If the water supply pressure is below 0.07Mpa (such as the water tank on rooftop), please take out the regulator referring to below pictures.

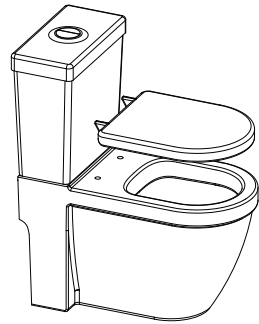
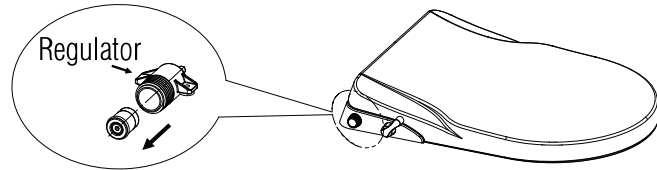

① Disassemble and remove the old toilet seat.

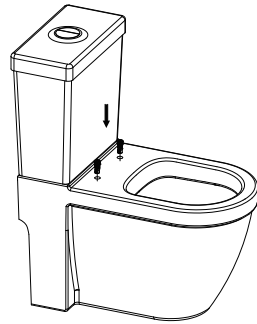

② Insert spigots into the pan holes.

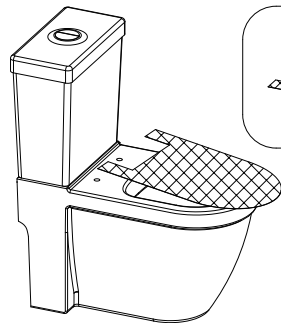

③ Align the template with the pan.

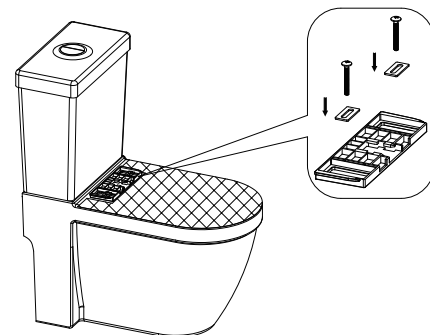

④ Position the fixing plate within template cut out, then install the bolts and washers.

INSTALLATION PROCEDURE

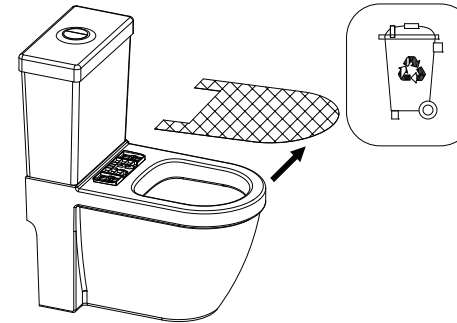

⑤ Remove the template.

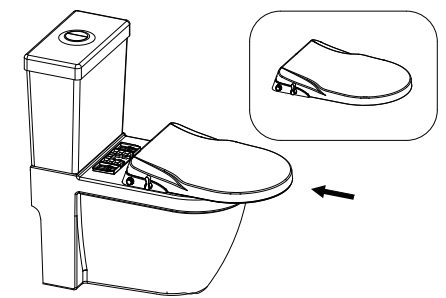

⑥ Whilst holding down the seat release button slide the bidet seat cover onto the fixing plate and push it to the end until a "click" is heard.

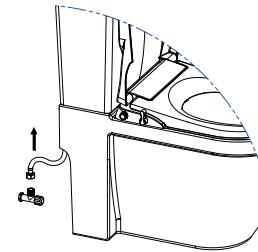

⑦-1 Turn off inlet valve and loose the flexible hose for tank.

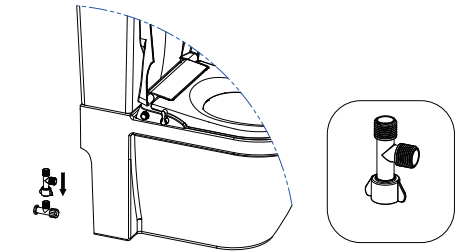

⑦-2 Connect the T shape adapter to the isolation valve, ensuring that the sealing washer is present in the T shape adapter.

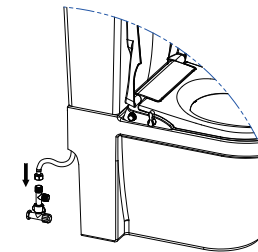

⑦-3 Install the inlet valve hose onto one end of the T shape adapter.

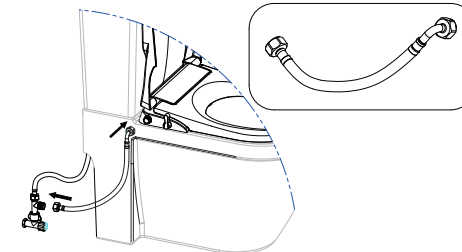

⑦-4 Install the bidet seat cover hose to the other end of the T shape adapter. Turn on water supply and check all joints for leaks.

MAINTENANCE

① Surface cleaning

Use a smooth sponge/ cloth with diluted kitchen detergent to clean the product. The following things are forbidden to use for surface cleaning: hydrogen chloride detergent, paint thinner, benzene, abrasive paper, polishing agent, fragrance and insecticide, etc.

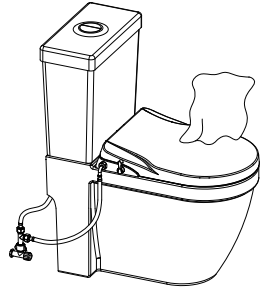

② Removing the seat

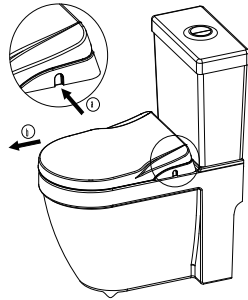

Keep the lid closed. Push and hold the seat release button on the side, then slide the seat towards the front of the pan as shown above.

③ Nozzle cleaning

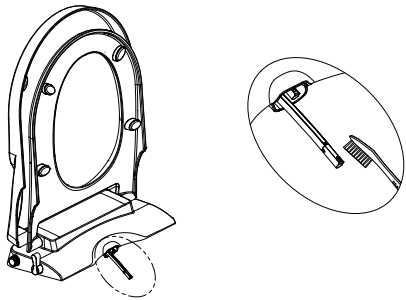

Pull out the nozzle softly and clean with a cloth/ sponge or toothbrush and a mild kitchen detergent.

④ Nozzle replacement

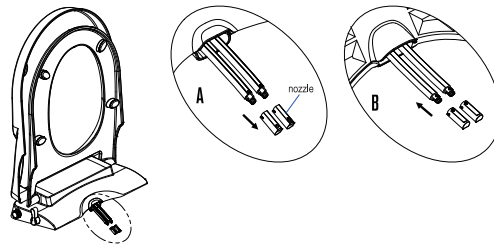

- 1、 Pull out the nozzle softly and hold the tube. Remove the nozzle along the arrow direction as shown in the figure A.
- 2、 Hold the tube and insert the new nozzle along the arrow direction as shown in figure B.

⑤ Control knob replacement

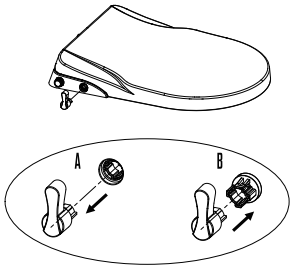

- 1、 Pull out the old control knob along the arrow direction as shown in figure A.
- 2、 Insert the new control knob along the arrow direction until "click" is heard as shown in figure B.

⑥ Regulator replacement

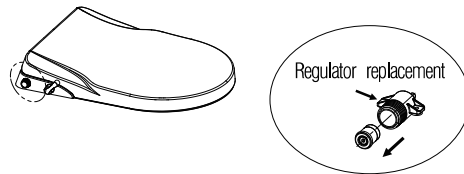

- 1、 Remove the bidet seat from the pan. Pull out the regulator from the water inlet tube with a tool shown as above figure.
- 2、 Insert the new regulator into the inlet tube.

TROUBLE SHOOTING

| Status | Cause | Solution |
|-----------------------------------------------------------------------------------|-----------------------------------------------|---------------------------------------------------------------------------------------------------------------------|
| Weak spray | Bidet valve is not fully opening | Ensure the control knob is fully turned to the maximum position. |
| | Water pressure is below 0.07Mpa | Remove the regulator reference step 6 in maintenance instruction, pls contact the service if it still doesn't work. |
| No water is coming out of the nozzle | Isolation valve is closed | Open the isolation valve. |
| | Filter screen in the flexible hose is blocked | Clean the filter screen. |
| | Nozzle is stuck | Take off the nozzle and clean it. |
| | Water supply pressure is too low | Increase the external water pressure. |
| Water leaking from the bidet seat base | Water supply pressure is too high | Ensure the maximum pressure does not exceed 0.8Mpa. |
| If any failure still occurs after above trouble shooting, pls contact the service | | |